

A A R Y A N
anmal
3 BHK DREAM DESTINATION



Based in Ahmedabad, Aaryan Projects has been offering to its customers beyond better homes since over two decades. The group has taken living to higher echelons in Ahmedabad's Real Estate Industry and is dedicated to developing residential projects with the best of amenities and quality. Our designs are an attempt at rejuvenating ideas and creating a contemporary lifestyle and next-generation features to add to our reputation.

Our goal is to work with honesty, integrity & transparency, thereby adhering to the highest ethical standards, while remaining committed to quality, customer service & on-time delivery. Our vision is to be one of the leading & most trustworthy names in the Real Estate Industry.

THE BEAUTY
OF  LIFE
AWAITS YOU



SHILAJ
SINDHU BHAVAN EXTENSION ROAD



A A R Y A N
anmol
3 BHK DREAM DESTINATION

A PERFECT PICTURE OF
CLASS, COMFORT & CONVENIENCE

Aaryan Anmol is designed to perfection with needs of its residents who are accustomed to ultramodern lifestyle of the present era. The perfectly planned 3 BHK Homes show you what luxury living looks like. From your safety to your lifestyle, at Aaryan Anmol we have taken care of everything in the most beautiful way.

14 STOREYS OF LUXURY

PURELY RESIDENTIAL
42 EXCLUSIVE UNITS
PREMIUM LOCATION





 A PLACE OF *Your Dreams*

AARYAN
anmal 



PREMIUM *Planning*
 FOR PLUSH *Homes!*

THOUGHTFUL AMENITIES FOR YOUR LIFESTYLE



ATTRACTIVE
 ENTRANCE GATE



SECURITY
 CABIN



AIR-CONDITIONED
 ENTRANCE FOYER



ALLOTTED CAR
 PARKING



LANDSCAPED
 GARDEN



JOGGING
 TRACK



SENIOR CITIZEN
 SIT OUT



WATER
 BODY



YOGA DECK



WELL EQUIPPED
 GYM



MULTY PURPOSE
 HALL



KIDS' PLAY
 AREA



GAZEBO



PARTY LAWN



 LISTEN TO *Life* EVERYDAY

AARYAN
anmol 

BASEMENT PLAN

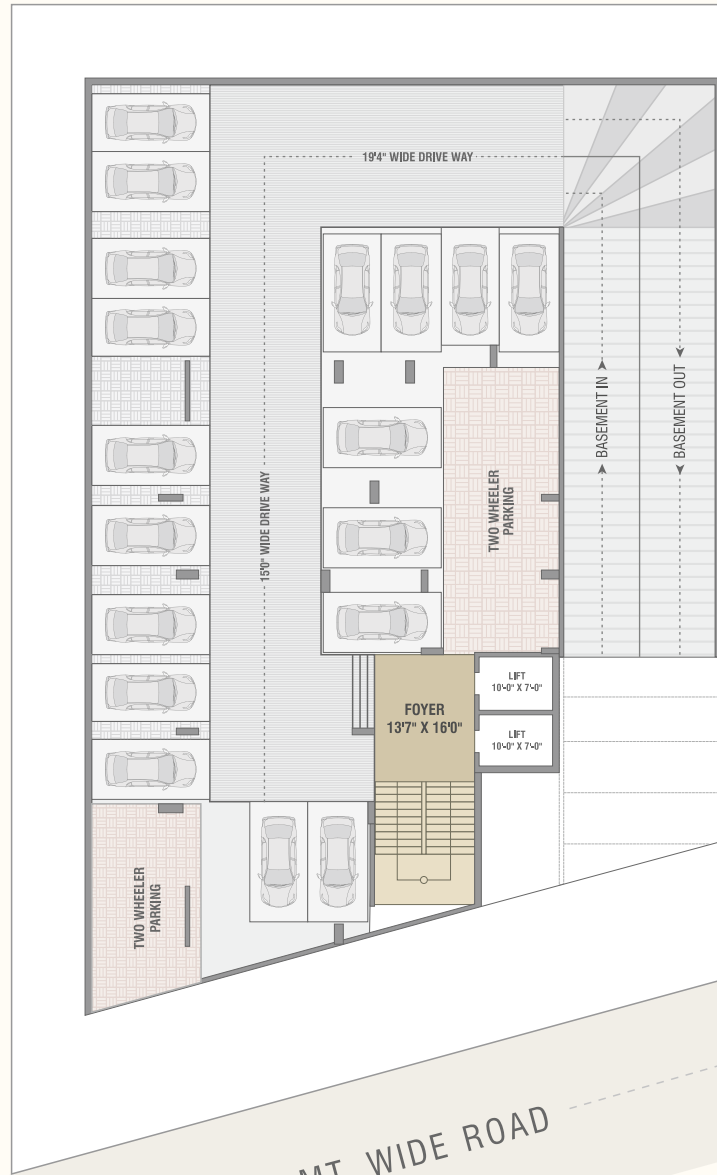

GROUND FLOOR PLAN

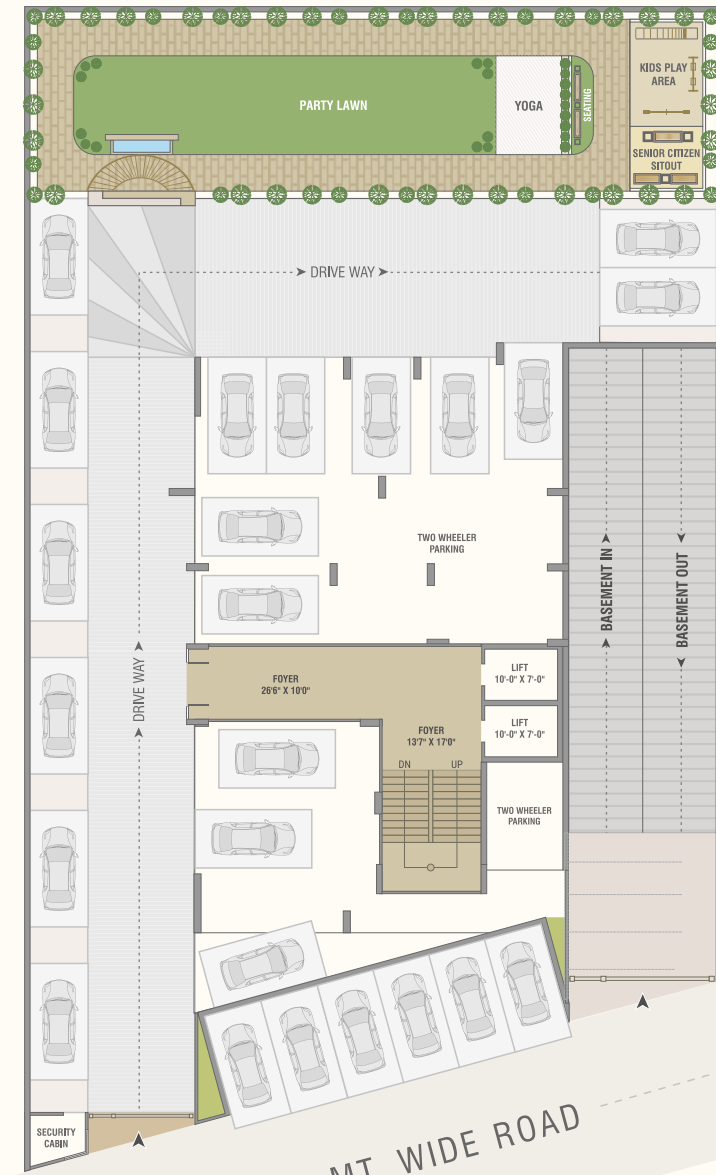

1ST FLOOR
PLAN



2ND TO 14TH FLOOR
PLAN



18.00 MT. WIDE ROAD

18.00 MT. WIDE ROAD

3 BHK UNIT PLAN

1ST TO 14TH FLOOR





SPECIFICATIONS



STRUCTURE

- Earthquake resistant R.C.C. frame structure with sand block walls.



FLOORING

- 4x2ft Vitrified flooring in living, dining, kitchen & all bedrooms.



KITCHEN

- Mirror polished granite platform with S.S. Sink.
- Tile dado up to lintel level on wall above the kitchen platform.
- Service platform with adequate storage space.
- Provision for exhaust fan.



DOORS

- Both side laminated flush door with wooden frame. Standard quality fittings for all doors.



WINDOWS

- Aluminum sliding windows with natural stone window jambs.



ELECTRIFICATION

- 3 Phase power supply.
- Modular switches, copper wiring & Safety switch gear.
- Sufficient power outlets & light points provided.



BATHROOMS

- Anti-skid ceramic tiles for flooring.
- Tile dado up to lintel level.
- European type w/c pan in all bathrooms.
- Cera or equivalent sanitaryware & C.P. fittings.
- Waterproofing in all bathrooms.
- Exhaust fan provision.
- Geyser point in all bathrooms.
- Rigid PVC pipes for drainage & plumbing.



TERRACE

- Terrace finished with water proofing & china mosaic for heat reflection.



COLOUR & WALL FINISH

- Internal wall :
Single mala plaster with putty (ready to paint)
- External wall :
Double coat sand face plaster with 100% acrylic water proof paint.

A PROJECT BY



GROUP
COMPANIES



Regd. Office : B/1103, Titanium Square,
Thaltej Cross Road, S.G. Highway, Ahmedabad. Tel. 079-2970 2629

FOR INQUIRY, CONTACT : +91 99251 16810; 99250 16810

www.aaryanheights.com/aaryananmol

ARCHITECT



**neha
consultant**

MAP & STRUCTURE ENGINEER
SETU INFRASTRUCTURE

RERA REGISTRATION NO.:

PR/GJ/AHMEDABAD/DASKROI/Ahmedabad Municipal Corporation/
RN32AA09932/170522 | www.gujrera.gujarat.gov.in

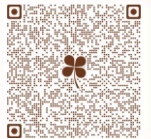

SCAN FOR
LOCATION

Design & Production by : www.creative9.in | +91 9898986869